

antariksh

A CELESTIAL CELEBRATION





ARTIST'S IMPRESSION

Lift your fingers and
touch the ephemeral skies...
For there lies the magic that
buoys you myriad heavens high...



Stairway to the Stars

Enter the realm of distinctly ethereal living spaces that are synonymous with peaceful havens of bliss. A towering symbol of class, elegance and luxury aptly named ANTARIKSH- your gateway to heaven. A multi-storeyed elegantly crafted architectural marvel poised in the heart of Borivali, that speaks volumes about the sheer flair and finesse that has gone into erecting a home that casts a glowing impression on the minds of most.

Come home to beautifully conceptualized 2 and 3 bhk apartments with panoramic views that promise a glorious lifestyle which is second to none. With such marvellous settings, extraordinary view, mesmerizing interiors and strong exteriors; the project cocoons you in an enchanting world of your own.





ARTIST'S IMPRESSION



An Elevation of Elegance

Conceived as an all-inclusive living destination to fit and amplify your modern lifestyle, the project bears testimony to unique designs that make for a bold statement. Fashioned with a keen eye on detail and a penchant for perfection, the project boasts of podium parking with ramp, with amenity floor over podium hosting a recreation garden along with a children's play area.



antariksh

Transcend the Ordinary...

The elegant lobby with its harmonious balance between the great outdoors and the enriching indoors is designed to make you fall in love with a new quality of life.



- Vitrified Flooring in entire flat.
- Coloured glazed wall tiles in Bathroom with anti-skid ceramic tile flooring.
- Kitchen with granite platform and S. S. Sink.
- Anodized aluminum sliding windows.
- Branded sanitary ware and fixtures.
- Branded modular switches and fixtures.
- Concealed copper electrical wiring with adequate A.C., TV, Telephone points.

ARTIST'S IMPRESSION

A Play of Passion & Pleasure...



FLAT NO.	TYPE	RERA CARPET AREA SQ.FT.	BALCONY SQ.FT.
01	2 BHK	741	36
02	3 BHK	1053	56

FLAT NO.	TYPE	RERA CARPET AREA SQ.FT.	BALCONY SQ.FT.
03	3 BHK	1045	56
04	2 BHK	748	36

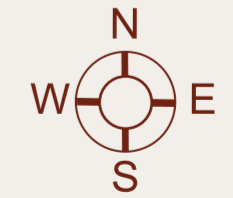
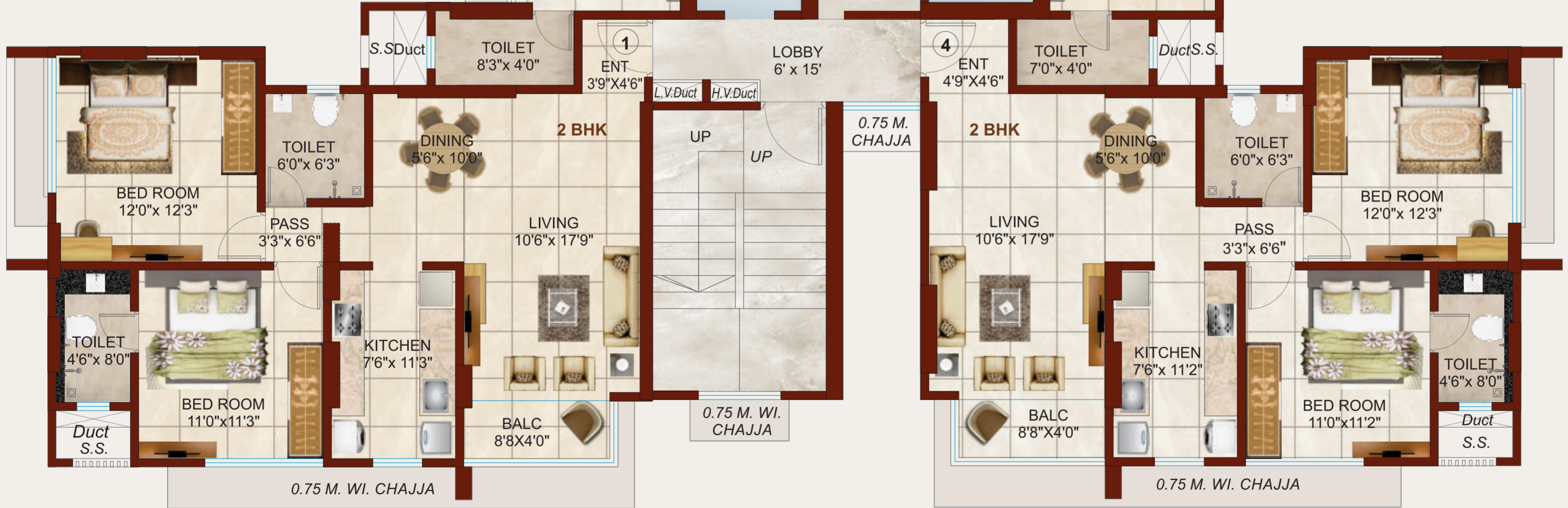



The Luxury of Leisure...

A home at ANTARIKSH is where you can relax, find comfort and experience the joys of finer living. Where you get to enjoy and revel in world-class amenities, a serene lifestyle and leisure features with your loved ones. With a range of

lifestyle amenities like a podium garden, exquisitely landscaped lawn and sitting areas along with a kids play area, everyday is a lesson to unwind and rejuvenate in the lap of languid tranquillity.





ARTIST'S IMPRESSION

- Grand Double Height Entrance Lobby
- Well equipped Gymnasium
- Amenity floor over podium
- Podium level parking with Ramp facility
- Lifts of reputed make
- Video door phones
- CCTV surveillance for common area

The Incline of Indulgence

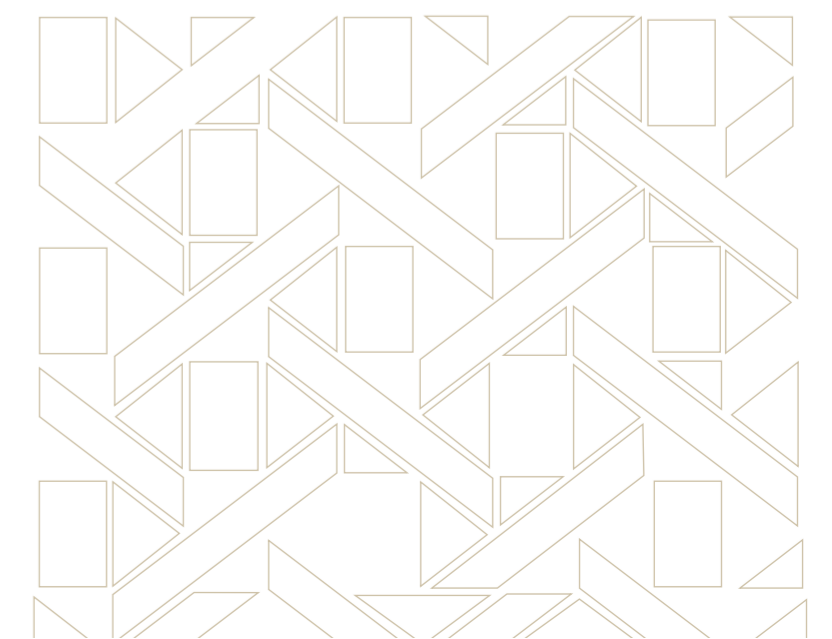



ARTIST'S IMPRESSION



SITE: ANTARIKSH (OM MAHESHWAR NIKETAN CO-OP. HSG SOCIETY LTD.) , CHANDAVARKAR ROAD, BORIVALI (W)

The Address of Exclusivity

Strategically located at Chandavarkar Road, ANTARIKSH is the ideal place for all your needs. Right in the heart of Borivali and close to S. V. Road, the project enjoys close proximity to the railway station and the metro rail on Link Road. It is well-located with great connectivity to all major social infrastructures like schools, hospitals, religious places, retail and entertainment hubs.



A Legacy of a Journey...

A Legacy of a Journey...Rakesh Shah, the visionary founder of Mahavir Land Developer, started out his entrepreneurial journey in Real Estate industry two decades ago. In last ten years, owing to his visionary thinking and his aptitude for making strategic business decisions, he successfully ventured into several residential projects of redevelopment in Mumbai.

Having amassed a wealth of experience with real estate ventures, Mr. Shah combined his expertise in managing multiple domains ranging from Finance, Aquisition, Planning, Development and Marketing with the principles of integrity, quality and innovative thinking, he has always stood for. Along with team of leading Architects, Structural and MEP Consultants, Mahavir Land Developer has completed many landmark projects in Kandivali, Borivali, Dahisar and Vasai.

Ongoing Project



NEELAAMBER - Mathuradas Road, Kandivali West



MahaRera Regn. No: P51800046045
Available on the website <https://maharera.mahaonline.gov.in>

Completed Projects



HELICON HEIGHTS - Link Road, Borivali West



THE CORNER - Link Road, Borivali West

DEVELOPERS:



MAHAVIR
LAND DEVELOPER
RAKESH SHAH REALTY

B / 210, WESTERN EDGE II, BEHIND METRO,
OFF. W. E. HIGHWAY, BORIVALI (EAST), MUMBAI 400 066.

T: 022 2870 7722 / 8822

E: mahavir.landdevelopers@gmail.com

W: www.mahavirlanddeveloper.com

PROJECT ARCHITECT
MANISH SHAH

CONSULTING ARCHITECT
P R CONSULTANTS

RCC CONSULTANT
ASCENT CONSULTING ENGINEERS



MahaRera Regn. No: **P51800034100** Available on the website <https://maharera.mahaonline.gov.in>

Disclaimer: The layout plan, the number/orientation of buildings/towers/wings/structures, the common areas, facilities and amenities, the fixtures, fittings, soft furnishing/furniture, gadgets, technology, information, pictures, images and visuals, drawings, specifications, sketches and other details herein are merely a creative imagination and an Architect's impression and are only indicative. The plans, designs, and dimensions are as per current sanctioned plans and approvals. Specifications, amenities, and facilities will be as set out in the agreement for sale as uploaded on the RERA website (<https://maharera.mahaonline.gov.in>) under Registration No. P51800034100. The same may be subject to modification/change/revision/alteration in terms of approvals, orders, directions and/or regulations of the concerned/relevant authorities, and/or for compliance with laws/regulations in force from time to time and/or in line with our customer policies. We may modify/alter the above by following due procedure as prescribed under the Real Estate (Regulation and Development) Act, 2017, ("RERA") read with the provisions of the Maharashtra Real Estate (Regulation and Development) (Registration of real estate projects, Registration of real estate agents, rates of interest and disclosures on website) Rules, 2017 and the Rules and Regulations framed under RERA for Maharashtra ("RERA Rules"). All dimensions mentioned in the drawings may vary/differ due to construction exigencies. Actual product may vary/differ from what is indicated herein. Further, dimensions mentioned on the floor plans are as per the plans approved by the MCGM and the same are subject to construction exigencies.